

# RB-2000-6 Roller-path type shot-blasting machine



## Application

The RB-2000-6 shot-blasting machine is mainly suitable for the de-rusting, de-scaling and cleaning of

- steel plates
- bar and sectional steel, pipes, profiles
- simple welded steel constructions.

## Description

The machine is equipped with six pieces of ABR 400 type blasting turbines. 2 of these turbines are situated above the roller-path top level and the other 2 ones are placed under it to ensure the optimal covering of the through-pass cross section. Blasting is done in a perpendicular angle to the direction of advancement.

The turbines are gravity fed with abrasive material, they have eight blasting blades and a pre-accelerator and they allow precise blasting direction adjustment.

The inner surfaces of the machine in the active zone are covered with highly wear-resistant manganese steel, other inner parts are protected by wear-resistant rubber sheet. This rubber cover has noise-reducing effect as well. Rollers in the machine house are also protected from the abrasive media by rubber cover that ensures quiet, slip-free conveying.

The three-layer rubber curtains at the inlet and outlet sluice prevent the high velocity abrasive particles from shooting out.

The closed and continuous circulation of the shot-blasting material is ensured by a screw conveyor, bucket elevator, abrasive cleaning wind-sifter unit and a feeding unit.

The clean work-piece is de-dusted by a brush cleaning aggregate built on the exit section and a blower fan.

The dust-aspirating and separating system of the equipment consists of galvanized steel air-ducts, form-elements, aspiration fan and filter cartridge inserted dust-separator.

Dust emission after the filter is not more than 3mg/m<sup>3</sup>.

All functions of the machine can be controlled from the central control box. Besides the normal mode of operation (automatic mode) manual mode is also available for maintenance purposes.



## Blasting pattern

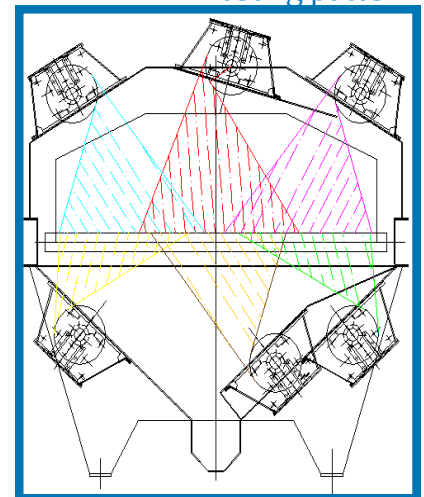

RB-2000/6



ABRAZIV Engineering Office and Machine Mfg. Ltd.

H-6000 Kecskemét, Paul Lechler u. 3.

WEB: [www.abraziv.hu](http://www.abraziv.hu)

Tel.: +36 (76) 815 - 900

Fax: +36 (76) 815 - 901

E-mail: [sbtech@abraziv.hu](mailto:sbtech@abraziv.hu)

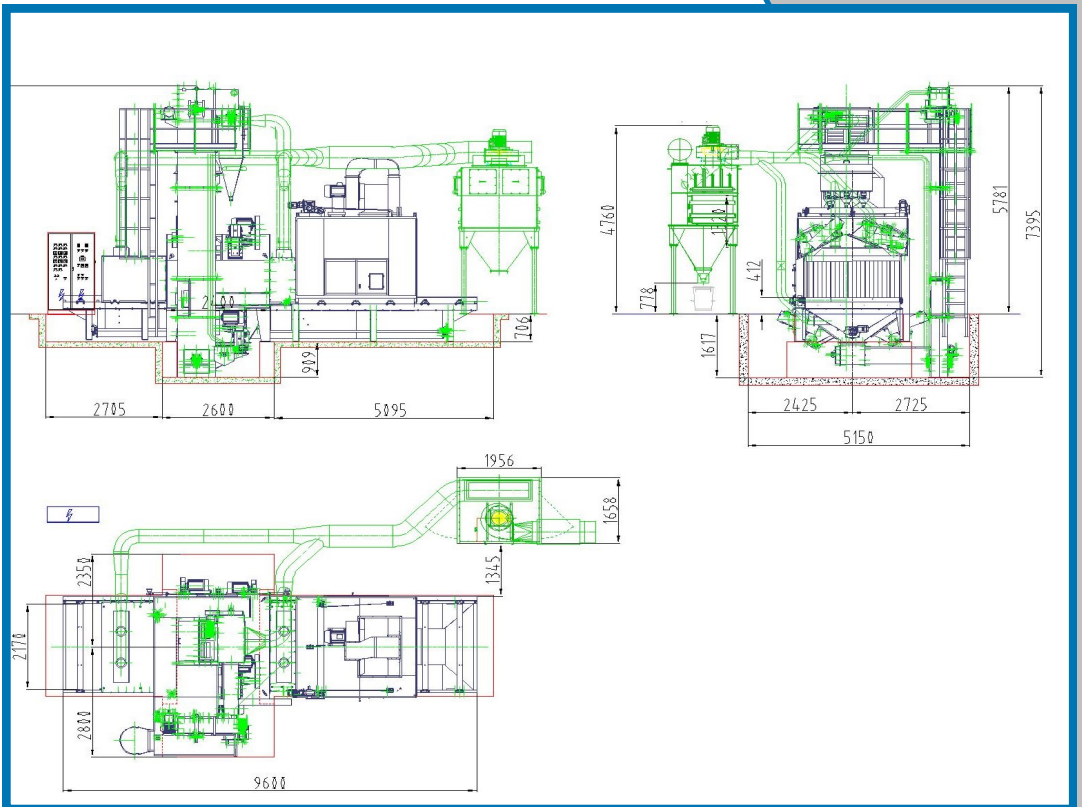

## Technical data

Through-pass width	mm	2000
Min. work-piece length (shorter pieces can be cleaned by means of a so-called auxiliary frame)	mm	about 2100
Max. height of work-piece	mm	800
<b>Turbines</b>		
Number	piece	6
Type		ABR-500
Diameter	mm	500
Wheel speed	1/min	2600
Abrasive capacity / per turbine	kg/min	150-360
<b>Rollerpath</b>		
Loadability	kg/m	1500
Speed range	m/min	0-4
<b>Energy demand</b>		
<b>Electrical</b>		
Basic machine	kW	59/140
Dust aspiration	kW	11
<b>Compressed air</b>		
Pressure	bar	min.6
Quantity (filter)	m <sup>3</sup> /h	15
Abrasive charge	kg	4500
Proposed abrasive particle size	mm	0,4-1,6
Air to be aspirated	m <sup>3</sup> /h	12000
<b>Electrical data</b>		
Mains voltage	V	3 x 400
Control voltage	V	240
Frequency	Hz	50