

Shot-blasting Machine type AH-1 with TUMBLING



Application

The AH-1 type machine was designed to clean the surface of cast, forged and pressed parts in bulk.

Technical description

The AH-1 type shot-blasting machine is mainly used for the cleaning of cast, forged and pressed parts in bulk.

The equipment has one turbine type ABR 380. The turbine is a 6-blade construction of axial, gravity abrasive supply. It is equipped with a mechanical pre-accelerator, having exact blast-jet direction adjustment.

The parts to be cleaned can be placed onto tumbling manually or with the help of a hydraulic loader.

The work-pieces in the blasting space roll on each other with the tumbling revolving. In the meantime the blast material cleans their whole surface.

The quantity of abrasive material and the blast time can be adjusted continuously to get optimal surface cleaning. There is an option to adjust the revolt number of the wheel. The speed of the shot material can be decreased or increased by changing the revolt speed of the wheel.

The inner walls of the blasting cabinet are protected by means of highly wear resistant manganese steel coverplates.

Blasting can only take place with the front door in closed position, this provides total protection against undesired abrasive leakage into the workshop space.

The closed and continuous circulation of the abrasive material is ensured by a screw, a bucket elevator, an abrasive cleaning unit and a feeder tank.

The clean parts can be discharged from the blasting cabinet by simply changing the direction of the tumbling drive.

To aspirate and separate the dust created by shot-blasting, we can supply cartridge type dust filter c/w fan, silencer and ductwork.

The equipment can be operated by means of central electrical control box.

Blasting pattern

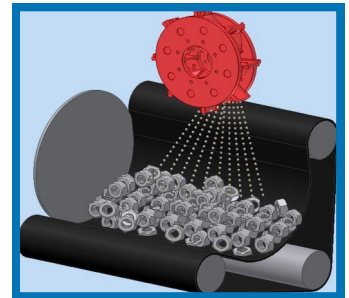

AH-1





Measure print /AH-1/

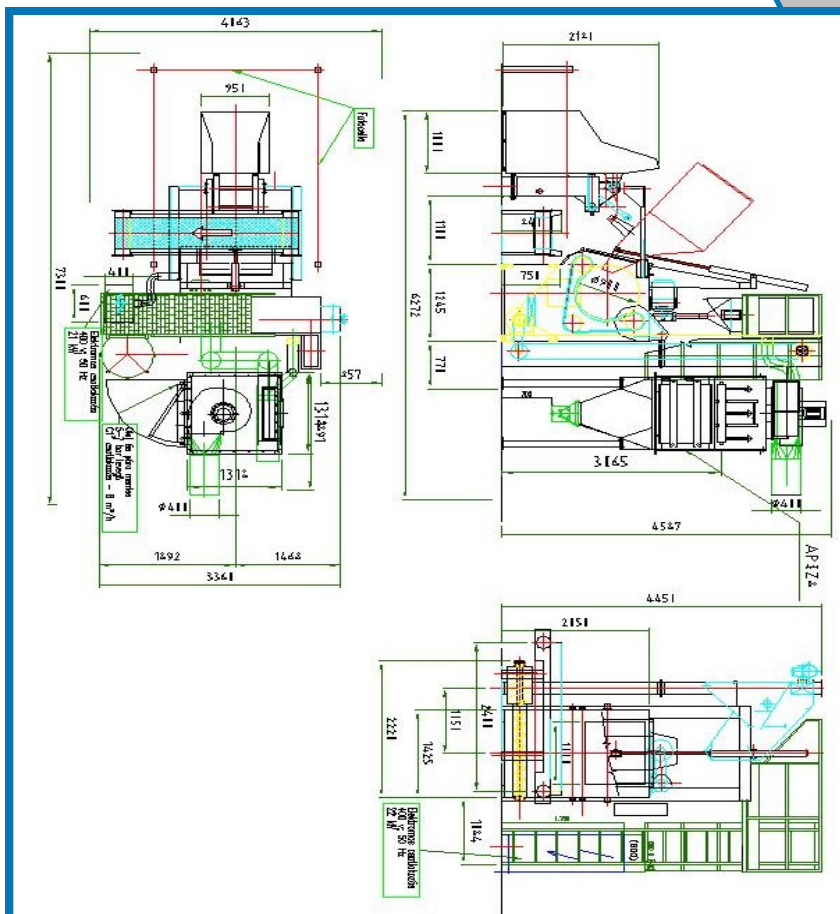

Technical data

Tumbling belt	Disc diameter	mm	900	
	Belt width	mm	1000	
Turbine	Number	pc	1	
	Type		ABR-380	
	Diameter	mm	380	
	Revolution speed	RPM	2600	
	Abrasive flow rate	kg/min	150	
	Turbine performance	kW	11	
	Work piece	Bulk load	kg	1000
Supplies	Electrical	Machine	kW	22,1
		Aspiration	kW	4
	Compressed air	Pressure	bar	6
		Flow rate	m ³ /h	8
Abrasive load		kg	500	
Proposed abrasive size		mm	0,4-1,2	
Aspiration airflow		m ³ /h	5000	
Electricity	Voltage	V	3 x 400	
	Control voltage	V	110	
	Frequency	Hz	50	